



RCTC

**RIVERSIDE
COUNTY
TRANSPORTATION
COMMISSION**

15 EXPRESS LANES UPDATE

NORCO TOWN HALL MEETING

JANUARY 27, 2020

15 EXPRESS LANES UPDATE



Project features

- Two express lanes in median, both directions
- Approx 15 miles –
Route 60 to Cajalco Road
- Widening 11 bridges
- Multiple entry/exit points
- \$472 million investment



Benefits

- 3,300 construction jobs
- Expands travel choices
- Supports future express bus service
- Carpool discounts
- Travel time reliability



Construction milestones



- Began work spring 2018
- Overall design-build effort is 63% complete
- Construction expected to be complete second half of 2020

Construction highlights

- Widening of Santa Ana River Bridge – Last girder delivered Nov. 14
- Paving in median complete north of 91
- Paving occurring south of Ontario Ave.
- New overhead signs installed
- Continuing drainage, electrical, tolling infrastructure work



Safety: Our top priority

- 55 mph speed limit – fines doubled in construction zone
- Orange barrels mean that lanes are closed – DO NOT drive in median – workers are present
- Watch for lane, ramp closures
- RCTC funding Freeway Service Patrols





15/91 Express Lanes Connector

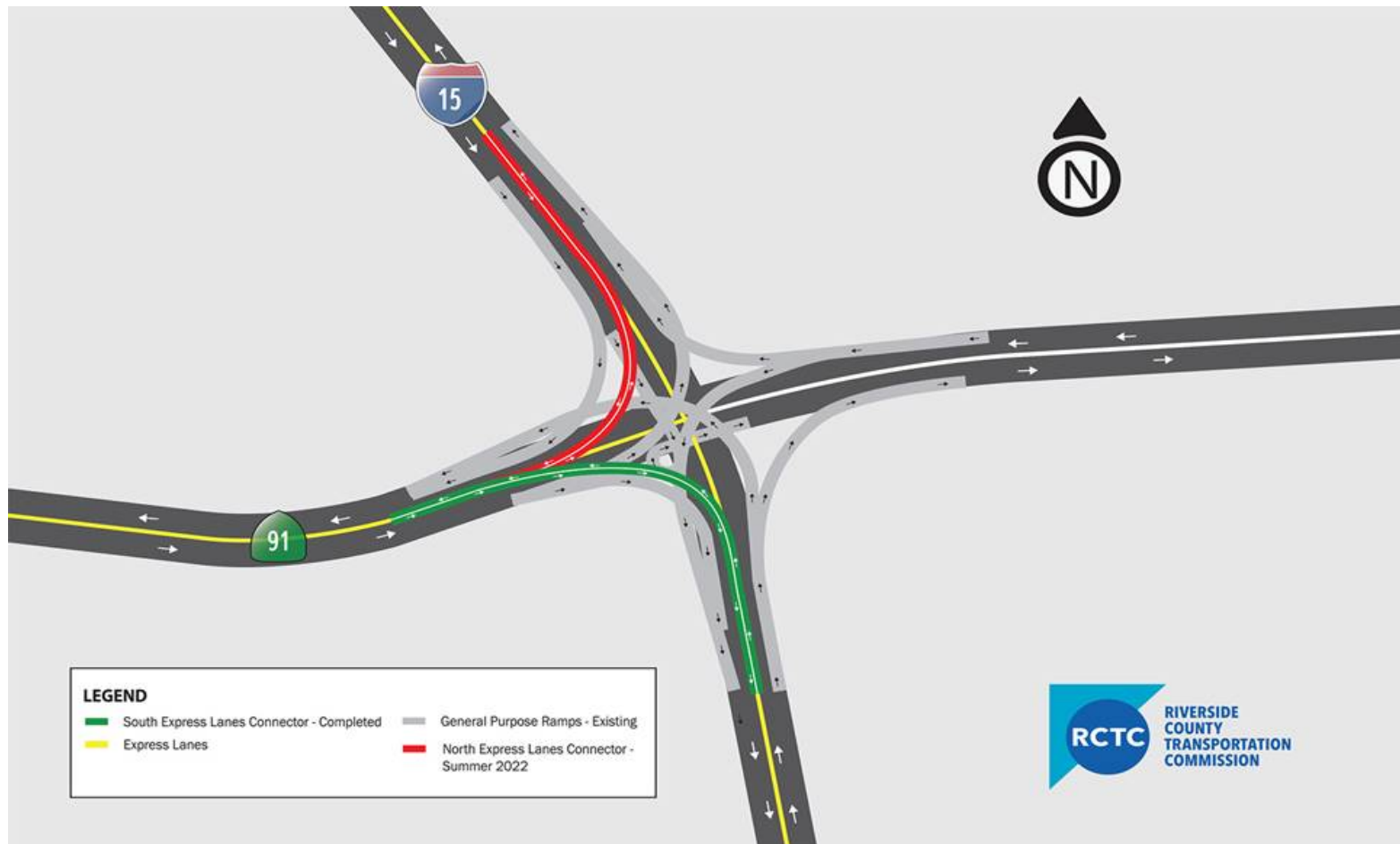



Stay Connected

15project@rctc.org

15project.info

(844) 415-9777

15ExpressLanes

RIVERSIDE COUNTY TRANSPORTATION COMMISSION



RCTC

**RIVERSIDE
COUNTY
TRANSPORTATION
COMMISSION**

QUESTIONS, DISCUSSION

